



KONTOS FOODS INC.

DOUGH PROOFING ROOM - PATERSON, NJ 07544



CR-300 CLEAN ROOM System Supplied and Designed By:
Johnson Building Systems, Inc.

975 Jaymor Rd - Southampton, PA 18966-3854

Tel: 800-445-7249 or (215) 673-6050 Fax: (215) 322-2076 E-Mail: Sales@JohnsonEnergyGroup.com



CR-300 CLEANROOM WALL PANEL SYSTEMS

WHITE FRP, PVC OR WHITE SMOOTH GALVANIZED

INSOLRAE Panel Systems are composed of .090" White FRP or White Smooth Galvanized with EPS solid core insulation or Non-Insulated PVC Panel for corrosion resistant clean room applications.

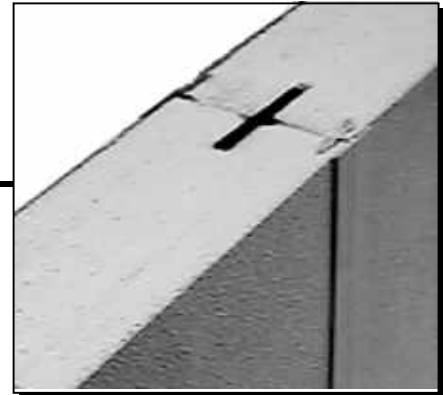

3" Insulated Wall Panels (Actual 2-3/4")

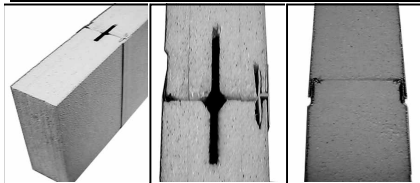

**USDA
White
HIGH
GLOSS
FINISH**

The INSOLRAE Aluminum "T" Bar System is excellent for indoor suspended ceilings, presenting heavy duty structural load bearing with USDA white panel finish. Unlike 2' x 4' Ceiling Panels, this system has a cleaner appearance.

Electrical Chase Available
Vertical or Horizontal
Add. \$.10 / sq.ft.

CEILING "T" SYSTEM

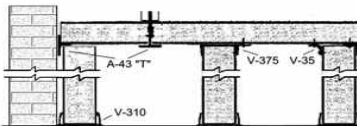

SELF SUPPORT SYSTEM

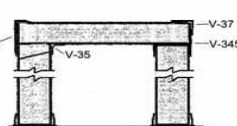

3" PVC Wall Panels (Actual 2-3/4")

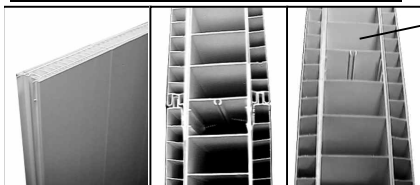

Center
Cavity for
Electrical
Chase
and or
return air
duct

8', 10' & 12' Clear Span
resulting in less
infiltration and
continuous
vapor barrier.

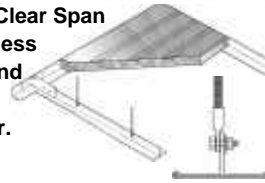

Optional: V-43 x 8' "T" Bar Flat Cover



Prod.No.	45" wide Panels are manufactured from 8' to Clear Span 24' high with EPS Solid Core Insulation (Except for CR-300BPV)				Price Sq.Ft.		
					2-3/4"		
					R-12		
CR300BF9	.090" Textured FRP Both Sides (White / Gray)				\$4.30		
CR300F9G	.090" White Textured FRP w/26 Ga.White Smooth Painted USDA Galv.w/Shadow Line				\$4.15		
CR300BGL	26 Ga. White Smooth Painted USDA Galvanized Both Sides w/Shadow Line				\$3.95		
CR300BPV	White PVC Smooth High Gloss Both Sides (Non-Insulated) Actual 36" Wide				\$6.95		
Prod.No.	White PVC and Aluminum Moldings:			EA. 8'	EA. 10'	EA. 12'	
V-121		1-1/2" x 1-1/2" INSIDE CORNER ANGLE		\$4.80	\$6.00	-	
V-35		2" x 2" INSIDE CORNER ANGLE		\$6.60	\$8.25	-	
V-123		1-1/2" x 1-1/2" OUTSIDE CORNER ANGLE		\$4.80	\$6.00	-	
V-37		2" x 2" OUTSIDE CORNER ANGLE		\$6.60	\$8.25	-	
V-119		PVC "H" BATTEN (1.125" FACE 13/16" LEG) (Max 16')		\$3.60	\$4.50	\$5.40	
V-375		2-3/4" CORNER CAP (2"x 5" LEGS) (White / Gray)		\$23.50	\$29.50	-	
V-345		2-3/4" LEDGE CAP (2"x 4" LEGS) (White / Gray)		\$24.90	-	-	
V-325		2-3/4" CAP (2" LEGS) (White / Gray)		\$19.30	-	-	
V-310		2-3/4" FLOOR SCREED (2-1/2" LEGS) (White / Gray / Black)		\$22.75	-	-	
G-315		WHITE 26 Ga. GALVANIZED 2-3/4" FLOOR CHANNEL (2"-1" LEGS)		\$11.95	\$14.90	-	
A-40		WHITE ALUMINUM 2" X 2" CORNER ANGLE (MAX 20' - \$53.00)		\$21.20	\$26.50	\$31.80	
A-46		WHITE ALUMINUM 3" X 3" CORNER ANGLE (MAX 20' - \$75.00)		\$30.00	\$37.50	\$45.00	
A-43		WHITE ALUMINUM 4" X 2" CEILING T-Bar (MAX 20' - \$80.00)		\$34.00	\$40.00	\$48.00	
PVC CORROSION RESISTANT COVERS				3/8" ZINC PLATED CEILING HARDWARE			
For use with A-40 and A-43 Aluminum Moldings				Net Price	2200	C-Clamps-Zinc Plated	\$1.35
V-43		4"x8' T-BAR FLAT (A-43)		\$6.40	4400-HD	Eye-Coupling w/nut&bolt	\$1.90
V-42		2"x2"x8' INSIDE CORNER (A-43)		\$6.40	1880	6' Redi Rod	\$2.25
V-41		2"x2"x8' OUTSIDE CORNER (A-40)		\$6.40	4420	Redi Rod Connector	\$0.35